

MEEG 2003 [Quiz #8.m23](#)

Determine the forces F_{DF} , F_{FG} , F_{CD} , and F_{BI} in members DF , FG , CD , and BI of the truss shown. Use T or C to indicate whether each of these forces is a *tensile* force or *compressive* force.

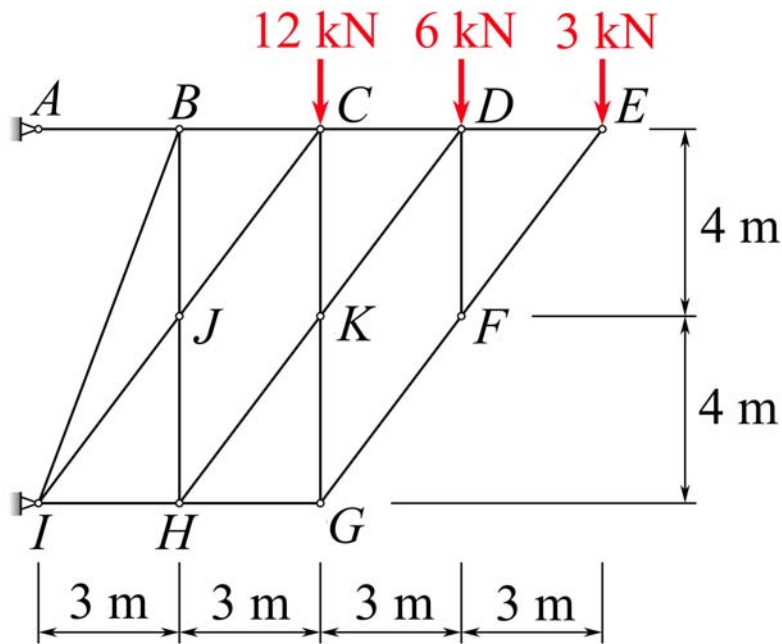

FBD's ②

$$F_{DF} = 0 \quad \text{②}$$

$$F_{FG} = 3.75 \text{ kN } C \quad \text{②}$$

$$F_{CD} = 6.75 \text{ kN } T \quad \text{②}$$

$$F_{BI} = 6\sqrt{73}/8 = 6.408 \quad F_{BI} = 6.41 \text{ kN } C \quad \text{②}$$