

MEEG 2003 Quiz #8.m24

Determine the forces F_{DE} , F_{EF} , F_{DK} , and F_{BJ} in members DE , EF , DK , and BJ of the truss shown. Use T or C to indicate whether each of these forces is a *tensile* force or *compressive* force.

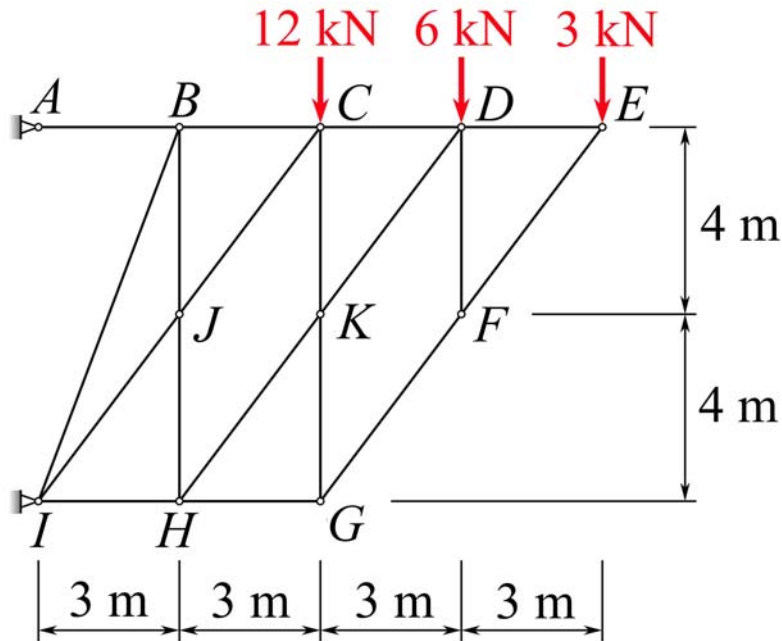

FBD's ②

$$F_{DE} = 2.25 \text{ kN } T \quad ②$$

$$F_{EF} = 3.75 \text{ kN } C \quad ②$$

$$F_{DK} = 7.5 \text{ kN } C \quad ②$$

$$F_{BJ} = 6 \text{ kN } T \quad ②$$